

2

1

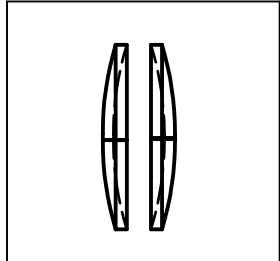

NOTE ORIENTATION OF DISK SPRINGS.  
TO PROPERLY PRE-LOAD BEARINGS FOR MINIMIZED VIBRATIONS.  
BE SURE TO INSTALL BOTH DISKS CONCAVE OUT AS SHOWN.

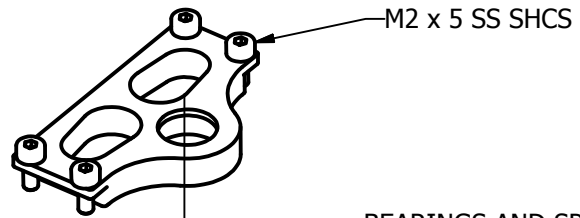

M2 x 5 SS SHCS

BEARINGS AND SPROCKET ASSEMBLY  
NOT INCLUDED. USE ORIGINAL FROM  
KIT.  
THE BEARINGS SHOULD STICK OUT OF  
THE BEARING CAP 0.5MM (0.02IN)  
WHEN FULLY SEATED

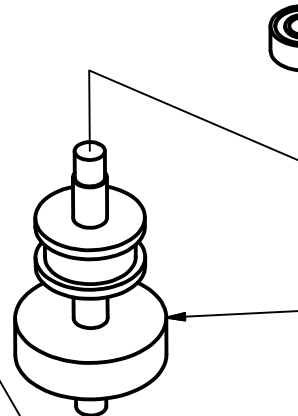

NOTE: FOR PROPER ALIGNMENT OF GEAR, DISK SPRINGS ARE TO BE INSTALLED ON  
THE BOTTOM OF THE SPROCKET ASSEMBLY AND THE LOWER MAIN ROTOR BEARING  
CAP INSTALLED WITH THE LOGO FACING UP.  
IF THE BEARING CAP IS LOGO FACING DOWN, IT MAY WORK BETTER WITH THESE  
SPRINGS ON TOP OF THE SPROCKET ASSEMBLY.  
HOWEVER, IF A TT ADAPTER IS INSTALLED, THESE SPRINGS MUST BE ON THE BOTTOM!

M2 TAPPED HOLES PROVIDED FOR ADDING  
A TRAY BY CUSTOMER. TRAY NOT SUPPLIED.  
USE THE FULL SCALE TEMPLATE BELOW.

M2.5 x 6 SS FHCS

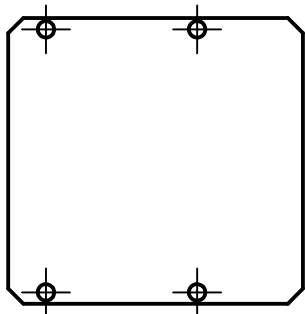

BEFORE ASSEMBLY TO TREX FRAME  
MARK THIS LOCATION AND DRILL  
1/8" (3MM) THROUGH RIGHT SIDE FRAME.  
FOR ACCESS TO CLAMP SCREW.

M2.5 x 8 SS SHCS

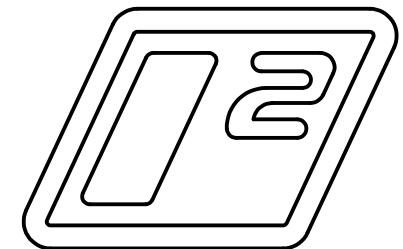
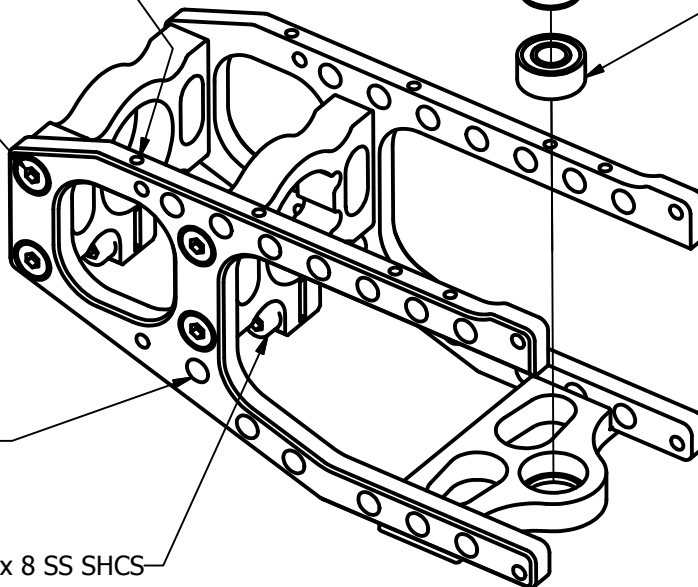

T500 Boom Mount

2

1



A

A

B

B